



World best forging company

**FASTENERS**

Construction  
Petrochemical Plant  
Heavy Equipment & Machinery  
Wind Power

**PARTS**

Automotive



# Greeting



Dear customers,

KPF, Corporation that is constantly growing and developing based on Management Philosophy involved in Efficiency, Diligence, Credit and Honesty, went beyond the half of century at founding manufacturing firm making forge welding parts for vehicle and Fastener for industry.

From now, KPF opened the new world as KPF VINA was founded in April 2010 and factory and office was also founded based on constant investment in Hai Duong.

KPF VINA, the number one corporation looking forward to the future, be focus on acquiring quality improvement and competitiveness corresponding with customers variety requirement.

KPF VINA will create the new corporate culture of Fastner industry with customer satisfaction management in the transitional world.

Please, the sustainable encouragement and concern of you by customers.

## History of KPF VINA

KPF, the corporation name changed in 2006 it was founded as calling 'KOREA BOLT' has been grown with customers, half of century.

From now, another half of century will start with KPF VINA.

- 'KPF' founded in 1963
- 'KOREA BOLT', Corporation name changed to 'KPF' (KOREA PARTS & FASTENERS)
- 2010.04 KPF VINA foreign branch founded ( Hai Duong, Vietnam)

2010.08	Founded Pilot Factory on Dai AN in Vietnam
2011.03	Start exporting items in Korean Market
2011.04	Start exporting items in Europe Market
2012.06	KPF VINA Opening ceremony hold
2012.08	Acquisition ISO 9001 : 2008 license
2012.10	Acquisition 10.9 license of Zinc plating from Wuerth
2013.09	Acquisition ISO14001 : 2004
2015.02	Acquisition EN15048-1 : 2007
2015.05	KS B1002 (4.8, 10.9)
2015.06	Started to sell Domestic market (Vietnam)
2015.07	Completed the new process (Annealing furnace for raw material) Completed the new process (Hop Dip Galvanizing)
2017.01	KS B1003 (grade 12.9)
2019.10	GEOMET / TOP Coating line launched
2020.02	ISO 17025 accredited





## 1 The company that specializes in hot and cold forging

Since founded in 1963, KPF have had leading-edge forging system and expanded its manufacturing facilities to lead to effective production cost at variety requirements of customers.

### Production Range

Hot Formed Parts	Out Dia.	35mm-105mm
	Height	25mm-80mm
Cold Formed Parts	Cutting Dia.	6mm-43mm
	Cutting Length	9mm-230mm
	Die K.O.	45mm-250mm



## 2 The company that specializes in heat treatment

The core technology for producing parts is heat treatment. KPF is highly experienced in manufacturing and produces higher quality of products through our technical KNOW-HOW Q/T (water cooling, oil cooling), Spheroidizing, Normalizing and so on. The core technology on the heat treatment satisfies customer needs.

## 3 The company that specializes in surface treatment

We are equipped with zinc plating, hot dip galvanizing process in-house to cope with our customer's various demands. We will try to live up to the customer's requirements installing High valued facilities for surface treatment in the future. Since Q4 2019, VINA plant launched GEOMET and TOP coating lines to provide our customers with more customized options.



## KPF VINA – Products Portfolio

KPF VINA is developing the new categories continuously to achieve excellent reputation by satisfying our customers. The manufacturing plant design and process design of the products don't stop doing our best to make it work.

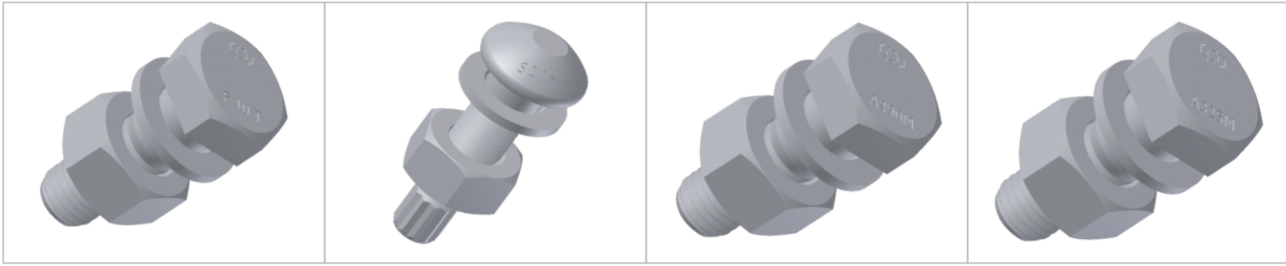

### High Strength Structural Bolts

JIS B1186  
Grade : F10T  
Surface : Plain, Zinc, Geomet  
Size Dia : M12-M24 (1/2"-1")  
Length : 35-240L (1/2"-91/2")

### Tension Control Bolts

JSS II-09  
Grade : S10T  
Surface : Plain, Zinc, Geomet  
Size Dia : M12-M24 (1/2"-1")  
Length : 35-240L (1/2"-91/2")

### High Strength Structural Bolts

ASTM  
Grade : A490, A490M  
Surface : Plain, Zinc, HDG  
Size Dia : M12-M24 (1/2"-1")  
Length : 35-240L (1/2"-91/2")

### High Strength Structural Bolts

ASTM  
Grade : A325, A325M  
Surface : Plain, Zinc, HDG  
Size Dia : M12-M24 (1/2"-1")  
Length : 35-240L (1/2"-91/2")

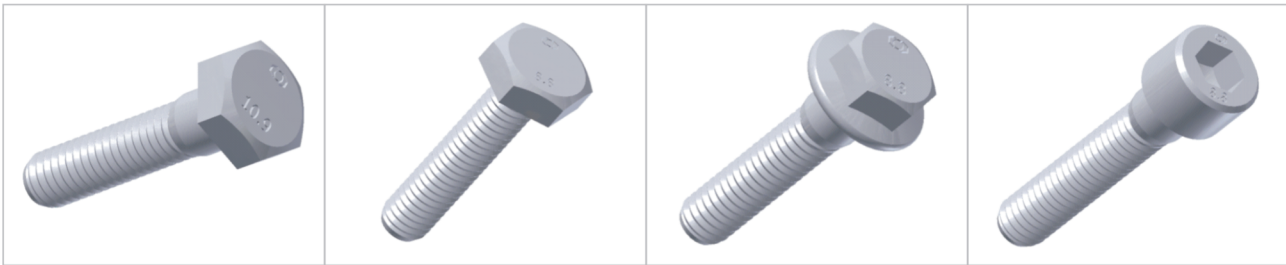

### Hex Bolts Screw

DIN 931, 960, ISO 4014, ASTM  
Grade : 8.8, 10.9, 12.9, Gr.5, Gr.8  
Surface : Plain, Zinc, HDG  
Size Dia : M6-M24 (1/4"-1")  
Length : 16-240L (5/8"-91/2")

### Hex Bolts Screw

DIN 933, DIN961, ISO4017, ASTM  
Grade : 8.8, 10.9, 12.9, Gr.5, Gr.8  
Surface : Plain, Zinc, HDG  
Size Dia : M6-M24 (1/4"-1")  
Length : 16-240L (5/8"-91/2")

### Hexagon Flange Bolts

DIN 6921, ASTM, IFI 1111  
Grade : 8.8, 10.9, 12.9, Gr.5, Gr.8  
Surface : Plain, Zinc  
Size Dia : M6-M20 (1/4"-3/4")  
Length : 16-240L (5/8"-91/2")

### Socket Bolts / Thin Head Cap Screw

DIN 912, 7984, ASTM  
Grade : 8.8, 10.9, 12.9, A574  
Surface : Plain, Zinc, HDG  
Size Dia : M6-M24 (1/4"-1")  
Length : 16-240L



### Hex Socket Countersunk Flat Head Cap

Screw ISO 10642 DIN 7991  
Grade : 8.8, 10.9  
Surface : Plain, Zinc  
Size Dia : M6-M20  
Length : 16-200L

### Round Head Square Neck Bolts

SAE, ASME B18.5  
Grade : A307, Gr.5, Gr.8  
Surface : Plain, Zinc  
Size Dia : M 6 - M 2 0 ( 1 / 4 " - 3/4")  
Length : 25-152L (1"-6")

### Hexagon Socket Button Head Screw

ISO 7380-1  
Grade : 8.8, 10.9  
Surface : Plain, Zinc  
Size Dia : M6-M16  
Length : 16-180L  
Length : 16-240L (5/8"-91/2")

### Hexagon Socket Button Head Screw

ISO 7380-2  
Grade : 8.8, 10.9  
Surface : Plain, Zinc  
Size Dia : M6-M16  
Length : 16-180L



### Double End Studs

Grade : 10.9, 12.9  
Surface : Zinc, Plain  
Size dia : M10-M20  
Length : 30-180L

### Thread Rod

Grade : B7  
Surface : Plain  
Size dia : 1/4"-2 1/2"  
Length : 12ft, 18ft

### Welding Studs

ISO 13918  
Grade : 5.8  
Surface : Plain  
Size Dia : M13-M25  
Length : 35-240L

### Stud Post Bolts

Grade : 4.8, 8.8  
Surface : Zinc  
Size Dia : M12-M24  
Length : 30-240L

## Facilities

KPF is consistently investigating to improve our facilities and making aggressive strategies to broaden our range of product lines with growing customers.

KPF invested to a new forging machine (a.k.a Long Former) to meet customer's a variety of requests for mid ranged sizes. Also, in order to meet high corrosion resistant demands toward high end market, KPF launched new GEOMET and Top coating lines of zinc plated items.

KPF have maintained the high efficiency of production through the systematically designed facility maintenance process.

As of 2022

No	Process	Size	Type	Line	Capa	
1	Spheroidizing Annealing (1 Line)	Ø6.5~Ø30	Batch Type	1	300Ton/Monthly	
2	Drawing & Coating (6 Lines)	Ø6.5~Ø30	G-BLOCK	6	5,100Ton/Monthly	
3	Forging & Rolling (28 Lines)	M6(1/4")	3D3B	2	M6x16~60	4,620Ton /Monthly
		M8(5/16")	4D4B	2	M8x16~60	
			3D3B	3		
		M10(3/8")	4D4B	1	M10x16~100	
			3D3B	6		
		M12(1/2", 7/16")	4D4B	2	M10x16~350	
			3D3B	4	M12x25~350	
		M14(9/16"), M16(5/8")	4D4B	4	M14x30~150	
M16x30~150						
M18, M20(3/4")	4D4B	2	M18x45~150			
			M20x45~150			
M22(7/8"), M24(1")	4D4B	2	M22x40~240			
			M24x40~240			
4	Thru Feed Thread Rolling (2 Lines)	1/4" ~ 7/8"	Max. Rolling Pressure30Ton	1	3ft, 6ft, 12ft	100Ton /Monthly
		1" ~ 2 1/2"	Max. Rolling Pressure60Ton	1	3ft, 6ft, 12ft	100Ton /Monthly
5	Heat Treatment (8 Lines)	M6(1/4")~M24(1")	RX-GAS	1	4,400Ton/Monthly	
			METHANOL	7		
6	Electroplated Coating (5 Lines)	M6(1/4")~M24(1")	BARREL (Auto)	4	2,000Ton/Monthly	
			BARREL (Manual)	1		
7	Hot Dip Galvanizing	M12(7/16")~M24(1")	Manual	1	300Ton/Monthly	
8	Zinc Flake Coating (2 Lines)	M6(1/4")~M24(1")	Base Coating	1	400Ton/Monthly	
			Top Coating	1	300Ton/Monthly	
9	Packing (12 Lines)	M6(1/4")~M24(1")	Manual	12	4,500Ton/Monthly	





## New product development

KPF VINA is initiated by being transferred its head quarter factory in the manufacturing process. Those items have been used under construction of steel structures and directed to Vietnam construction market. We will make the construction parts used for heavy equipments and construction.

### Construction

H/T Bolt-Nut-Washer  
T/S Bolt-Nut-Washer  
Welding Stud



### Installation Procedure

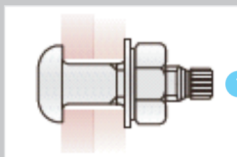

Install the T/C bolt through the structure, and engage a mating washer and nut. Nut and washer marking should face away from the connection.

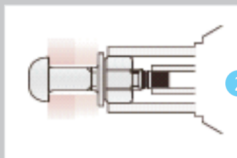

Snug-tighten the assembly to approximately 10% of assembly installation tension. Snug-tight can be achieved by a few impacts of an impact wrench or by full effort of a person using a standard spanner or preset torque wrench.

Slide the inner socket over the bolt pintail and the outer socket over the nut.

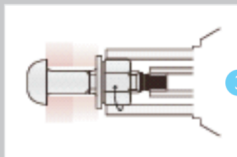

Switch the wrench on. The outer socket will rotate and tighten the nut until the bolt reaches the required tension. When the proper bolt tension is reached, the outer socket will stop rotating and the inner socket will rotate in the opposite direction and shear the pintail off.

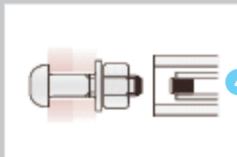

The bolt pintail is retained by the wrench and can be discarded by engaging the small trigger on the wrench handle.

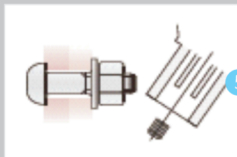

When the pintail has sheared off, pull back the wrench until the outer socket is no longer engaging the nut.

### Tightening Pattern

Snug-tightening and final tensioning of the bolts in a connection shall proceed from the stiffest part of the connection towards the free edges. An example interpretation of a systematic pattern for tightening provided :

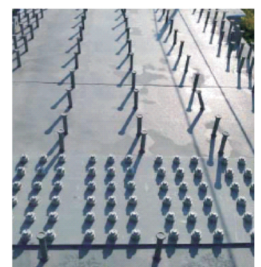
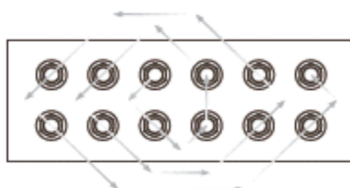

## Certification

KPF has several kinds of certificates to correspond with our customer needs. We are always ready for satisfying our END-USER's high quality requirement based on our authorized certificates.



▶ ISO 9001 : 2015  
ISO 14001 : 2015



▶ EN 15048-1 : 2007



▶ KS B1003(12.9)



▶ KS B1002(4.8, 10.9)



▶ ISO/IEC 17025 : 2017





Factory(Chungju)

50 Chungjusandan 5-ro, Chungju-si,  
Chungcheongbuk-do, Korea(Yongtan-  
Dong), Postal Code : 27327

TEL. +82-43-849-1114

FAX. +82-43-849-1279

KPF VINA company limited

Plot XN2, Dai An Expansion IZ, Hai  
Duong Province, Vietnam, Postal  
Code : 170000

TEL. +84-220-3555-567

FAX. +84-220-3555-126

Fasteners team(Pangyo)

Songhyuntower 6F, 136, Unjung-  
ro, Bundang-gu, Seongnam-si,  
Gyeonggi-do, Korea(Pangyo-dong),  
Postal Code : 13466

TEL. +82-31-8038-9700

FAX. +82-31-8038-9742

KPF Jinan Bearing Components

No 7100 Century Big Road, Zhangqiu  
City, Shandong Province, China

TEL. +86-531-5867-9166

FAX. +86-531-5867-9171

Automotive Parts Team(Pangyo)

Songhyuntower 4F, 136, Unjung-ro,

Bundang-gu, Seongnam-si, Gyeonggi-  
do, Korea(Pangyo-dong), Postal Code :  
13466

TEL. +82-31-8038-9772

FAX. +82-31-8038-9763

KPF USA

1701 E.Lake Ave. #442 Glenview,  
IL60025

TEL. +1-847-730-3376

FAX. +1-847-510-0580

Domestic Sales Office(Busan)

449, Hasinbeonyeong-ro, Sasang-  
gu, Busan, Korea(Eomgung-dong),  
Postal Code : 47033

TEL. +82-51-311-1650

FAX. +82-51-311-1654

KPF Europe(Germany)

Mergenthalerallee 77, 65760 Eschborn,  
Germany

TEL. +49-6196-9699115

[www.kpf-global.com](http://www.kpf-global.com)

